

Benitachell

Apartment for sale in Cumbre del Sol

Property ID: NE1425A



PURCHASE PRICE: 408.000 EUR • ROOMS: 3

Property ID: NE1425A - 03726 Benitachell

- At a glance
- The property
- Energy Data
- A first impression
- Contact partner

Property ID: NE1425A - 03726 Benitachell

At a glance

Property ID	NE1425A	Purchase Price	408.000 EUR
Rooms	3	Total Space	ca. 202 m ²
Bedrooms	3	Equipment	Swimming pool
Bathrooms	2		

Property ID: NE1425A - 03726 Benitachell

Energy Data

Energy Certificate	0.00
Final energy consumption	0.00 kWh/m ² a

Property ID: NE1425A - 03726 Benitachell

The property



Property ID: NE1425A - 03726 Benitachell

The property



Property ID: NE1425A - 03726 Benitachell

The property

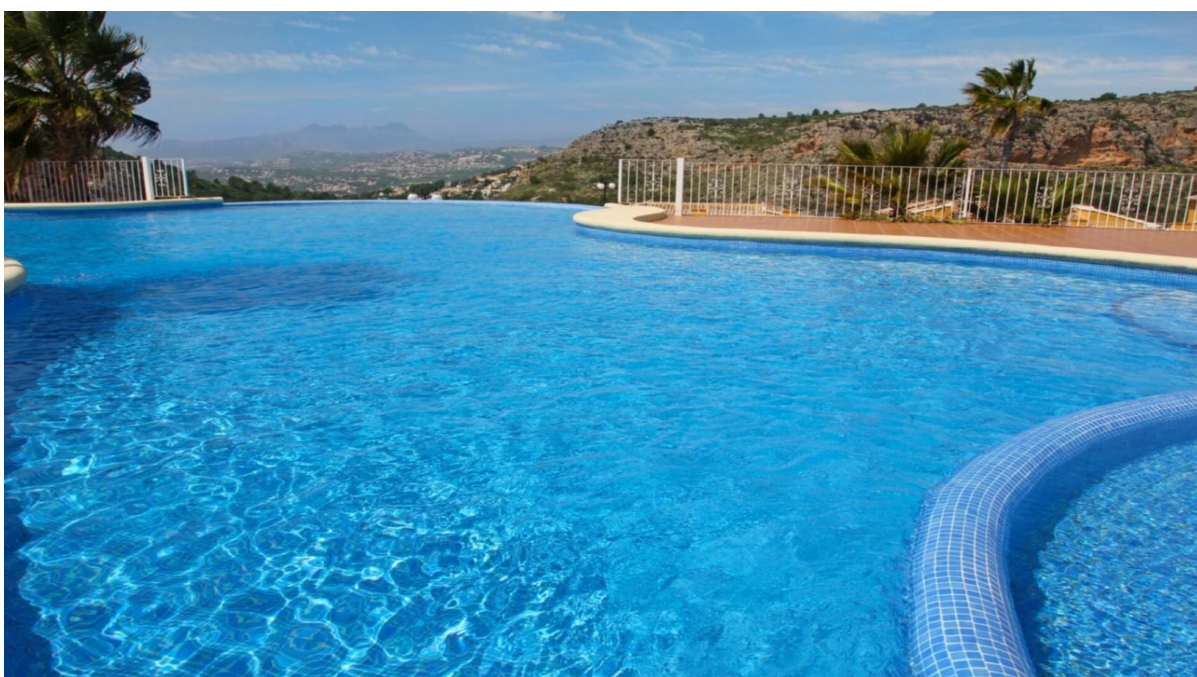

Property ID: NE1425A - 03726 Benitachell

The property

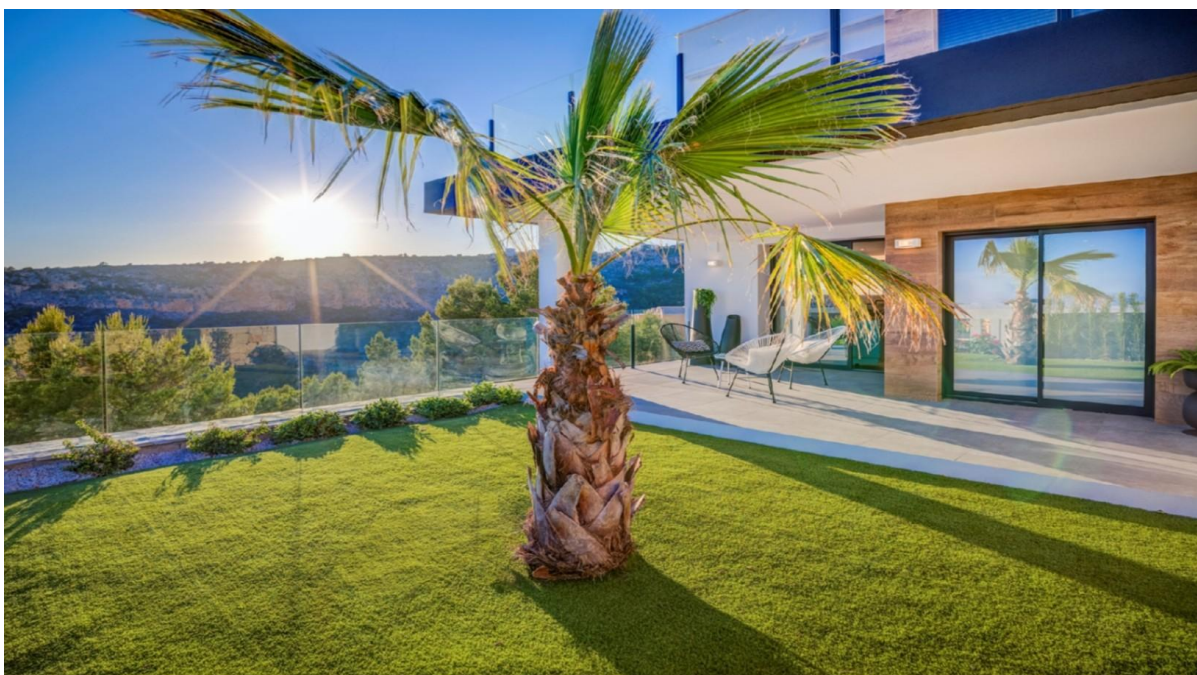

Property ID: NE1425A - 03726 Benitachell

The property



Property ID: NE1425A - 03726 Benitachell

The property



Property ID: NE1425A - 03726 Benitachell

The property



Property ID: NE1425A - 03726 Benitachell

A first impression

Characteristics:
New Built Apartments: These are newly constructed apartments. **Modern Architecture:** The apartments feature modern architectural design. This Penthouse has 3 bedrooms and 2 bathrooms.

Features:
Underfloor Heating: The presence of underfloor heating is a comfort feature. **Open Kitchen:** The kitchen is open to the living room, which is a contemporary design choice. Ground floor apartments have a terrace and garden, while top floor apartments have a solarium. **Comfort Features:** The apartments are equipped with underfloor heating, hot and cold air conditioning, a hot water system, electrical appliances, and a decoration project to enhance style and warmth. **Air Conditioning in the living room.** **Hot Water System:** Hot water is supplied through the Altherma system. **Appliances Included:** Electrical appliances are included, which is convenient for residents. Communal areas are designed for relaxation and family enjoyment, featuring a pool, large terraces for sunbathing, a playground for children, a social club, gardens, and parking areas.

Area: The apartments are located within a short distance to Cala del Llebeig, the urban core of Moraira, and all the services that Residential Resort Cumbre del Sol offers. The location is also described as convenient for access to amenities and natural features like Cala del Llebeig. Airport Alicante one hour drive

Commission free for buyer!
ONLY 7 properties available, prices from 408.000€ to 590.000€.
VON POLL COSTA BLANCA

Property ID: NE1425A - 03726 Benitachell

Contact partner

For further information, please contact your contact person:

Yohanne Pezham Goergens & Nicolai Jensen

Carrer Benidorm, 2 Costa Blanca
E-Mail: calpe@von-poll.com

To Disclaimer of von Poll Immobilien GmbH

www.von-poll.com